

Fig. 12—Rear Bumper Station Wagon Models

ALIGNMENT**Up and Down**

Adjustment of the door can be made at either the pillar or door hinge halves (Fig. 15).

In and Out

Adjustment is made at the door hinge half. **Adjust only one hinge at a time.** Raising outer end of door moves upper part of door forward, when in closed position. Lowering lower part of door moves lower part forward, when in closed position.

Fore and Aft

Adjustment is made at the pillar hinge half. **Adjust**

only one hinge at a time. Raising outer end of door, moves upper part of door into door opening. Lowering outer end of door, moves lower part of door into door opening.

STRIKER

The door strikers (Fig. 16) are attached to the pillars. Oversize holes permit up and down and in and out movement. Fore and aft adjustment is made by adding or removing shims between the striker and post. The striker bolt should be adjusted to lift the door slightly.

DOOR REPLACEMENT**Front Door (All Models)****Removal**

On vehicles with electric windows, disconnect the wires from window regulator motor and remove from door assembly.

(1) With door in wide open position, place a jack, with a block of wood or pad on lifting plate of jack, as near hinge as possible. (This will hold weight of door as hinge bolts are loosened.)

(2) Remove door interior trim and hardware.

(3) Scribe a line around upper and lower hinge plates on door panel.

(4) Remove hinge attaching screws from door and remove door for further disassembly if necessary.

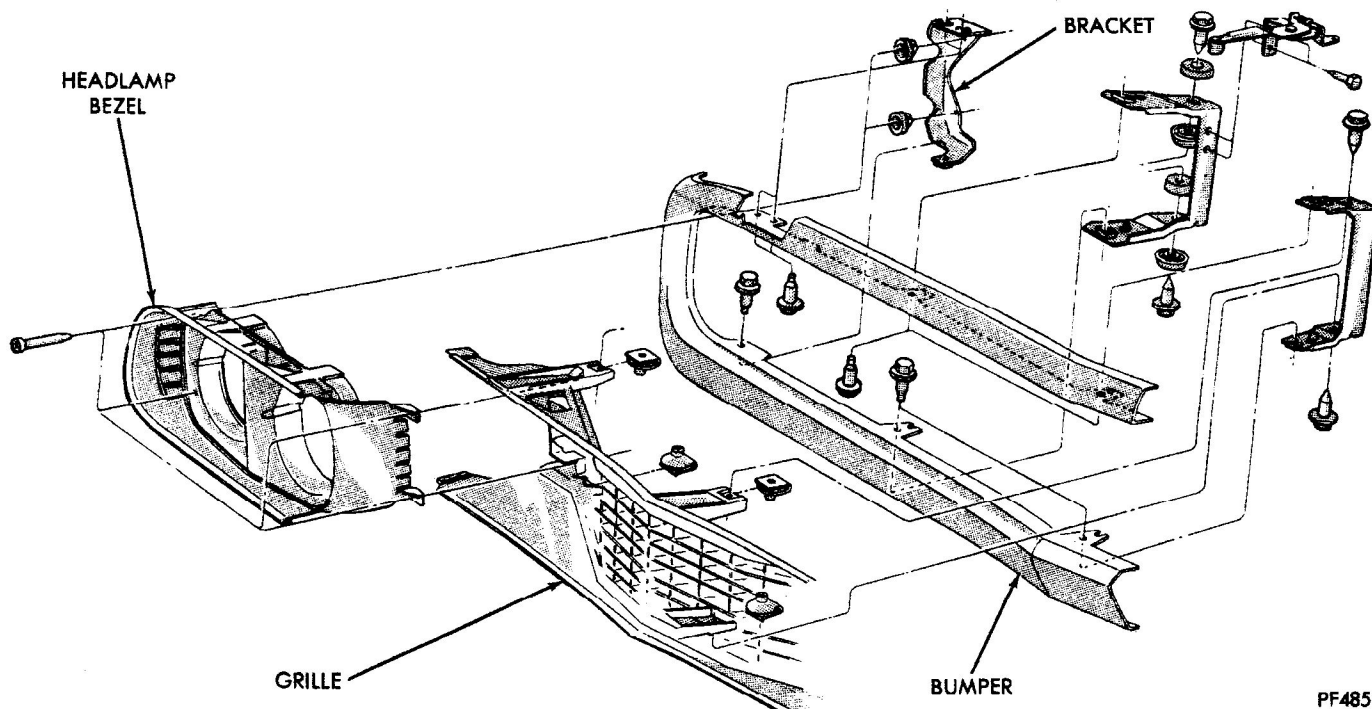

Fig. 13—Grille Attachment—Sedans