

WHEN INSTALLING WINDOW REGULATOR AND GLASS INTO CAR, INSTALLANTS SHALL APPLY LUBRICANT TO THE FOLLOWING AREAS PER PART 1906686 TO THE FOLLOWING AREAS PER PART 1906686

- 1 REGULATOR SECTOR TOOTH CONTACT AREA ON EXTERIOR SIDE APPROXIMATELY .50" WIDE ALONG ENTIRE LENGTH OF ARC.
- 2 TO THE REGULATOR FRONT AND REAR ARM STUDS
- 3 REGULATOR ARM PIVOT TO REGULATOR ARM PIVOT BRACKET SLIDING SURFACES
- 4 REGULATOR ARM ROLLER AND LOWER SLIDE ROLLER TO GLASS LOWER FRAME SLIDING CONTACT SURFACES.
- 5 WINDOW TRACK BRACKET, ROLLER AND GUIDE ASSEMBLY TO GLASS LOWER FRAME SLIDING CONTACT SURFACES.
- 6 TRACK SLIDE ASSY TO REAR ROLLER TRACK SLIDING CONTACT SURFACES

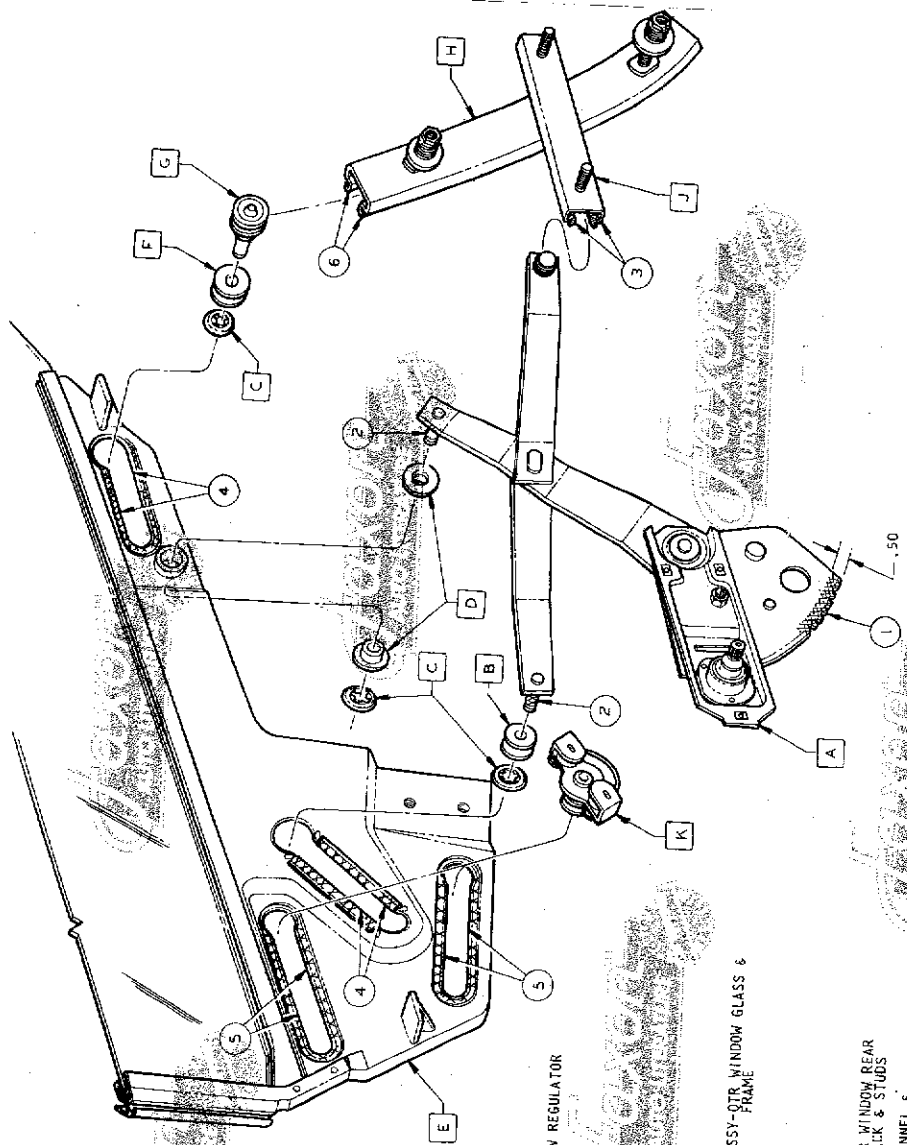

2583030-1 [MANUAL] (MOD 23) ASSY-QTR WINDOW REGULATOR
 2583030-2 [ELECTRIC] (MOD 29)
 2583030-3 [ELECTRIC] (MOD 29)
 2583030-4 [ELECTRIC] (MOD 29)

24-86982 ROLLER

6000305 SPRING NUT

2583551 BUSHING

2602066-7 [CLEAR] (S/O 2602066-7) (MOD 23) ASSY-QTR WINDOW GLASS & FRAME

2602068-9 [TINTED] (S/O 2602068-9) (MOD 23) ASSY-QTR WINDOW GLASS & FRAME

2603454-5 [CLEAR] (S/O 2603454-5) (MOD 29) ASSY-QTR WINDOW GLASS & FRAME

2603456-7 [TINTED] (S/O 2603456-7) (MOD 29) ASSY-QTR WINDOW GLASS & FRAME

2520616 ROLLER-QTR WINDOW TRACK SLIDE

2583552 ASSY-QTR WINDOW TRACK SLIDE

2603100 [OPT] (S/O 2603096) (MOD 23) ASSY-QTR WINDOW REAR TRACK & STUDS

2603335 [OPT] (S/O 2603334) (MOD 23) ASSY-QTR WINDOW REAR TRACK & STUDS

2603332 ASSY-QTR WINDOW REGULATOR ARM PIVOT CHANNEL & ROLLER & GUIDE

2520658 ASSY-QTR WINDOW TRACK BRACKET, ROLLER & GUIDE

FOR VENDOR APPLIED LUBRICATION SEE PURCHASED ASSEMBLY DRAWINGS

MODEL	BRW-O-23 & CWO-O-29
ENGINEERING	BRW-O-23 & BWO-O-29
DESIGN	DESIGN
CHECKED	CHECKED
DATE	DATE
BY	BY
FOR	FOR